

Automotive Engines 10th

Quiz 32B

MULTIPLE CHOICE. Choose the one alternative that best completes the statement or answers the question.

1. Most late model vehicles will use _____ as an intake manifold gasket. 1. _____
 - A) cork
 - B) cork-rubber
 - C) plastic/rubber
 - D) RTV

2. Which type of oil seal must NOT have oil applied to it for it to work correctly? 2. _____
 - A) Silicon rubber
 - B) Buna-N
 - C) Teflon
 - D) Viton

3. RTV (room temperature vulcanized) cures under which of these conditions? 3. _____
 - A) At room temperature
 - B) Moisture in the air
 - C) Without oxygen
 - D) Both A and B

4. Which of these is the head gasket? 4. _____

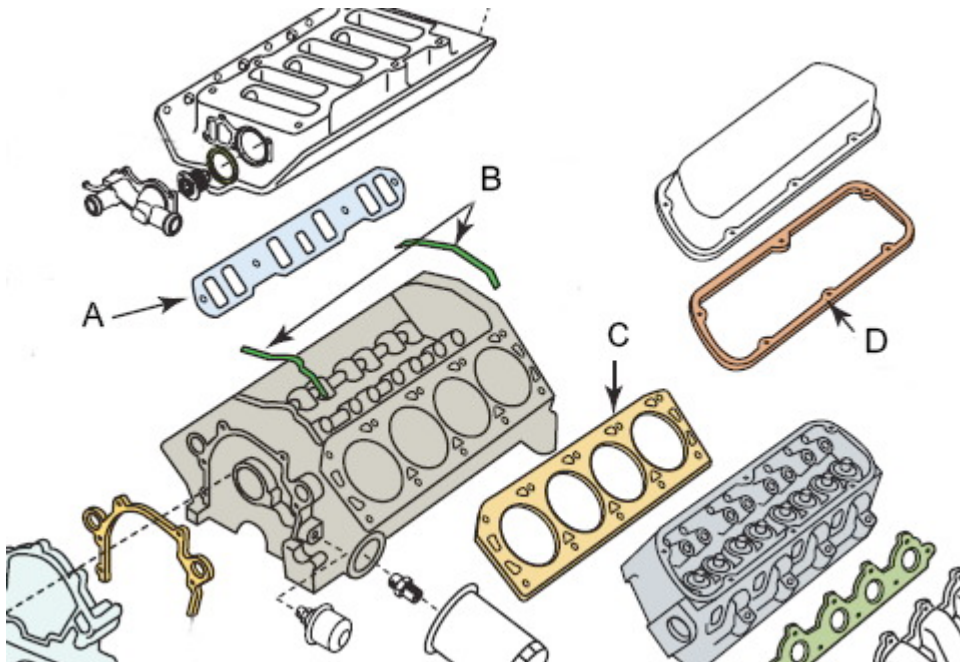

- A) A
- B) B
- C) C
- D) D

5. Technician A says that gaskets are used to fill a space or gap between two objects to prevent leakage from occurring. Technician B says that there are many types of gaskets including cylinder head gaskets, valve cover gaskets, and timing cover gaskets. Which technician is correct? 5. _____
- A) Technician A only
 - B) Technician B only
 - C) Both technicians A and B
 - D) Neither technician A nor B
6. Which type of sealer is to be used on non-machined surfaces? 6. _____
- A) RTV
 - B) Anaerobic sealer
 - C) Either A or B
 - D) Neither A nor B
7. A rear main seal is designed to keep coolant from leaking out of the engine. 7. _____
- A) True
 - B) False
8. A one piece oil pan gasket often uses _____ in the middle to add strength. 8. _____
- A) plastic (nylon)
 - B) steel
 - C) hard rubber
 - D) carbon fiber
9. Oil seals are made completely of a rubber-like, Buna-N material. 9. _____
- A) True
 - B) False
10. A gasket failure caused by the movement of dissimilar materials is called _____. 10. _____
- A) fretting
 - B) corrosion
 - C) collapsing
 - D) tearing

Answer Key

Testname: ENGINES 10 32B

1. C
Page Ref: 465
2. C
Page Ref: 467
3. D
Page Ref: 467
4. C
Page Ref: 463
5. C
Page Ref: 462
6. A
Page Ref: 469
7. B
Page Ref: 467
8. B
Page Ref: 465
9. B
Page Ref: 467
10. A
Page Ref: 466