

Automotive Engines 10th

Quiz 32A

MULTIPLE CHOICE. Choose the one alternative that best completes the statement or answers the question.

1. A rear main seal is designed to keep coolant from leaking out of the engine. 1. _____
 - A) True
 - B) False

2. Which type of oil seal must NOT have oil applied to it for it to work correctly? 2. _____
 - A) Silicon rubber
 - B) Buna-N
 - C) Teflon
 - D) Viton

3. Old style cork cover gaskets have been replaced by _____. 3. _____
 - A) cork-rubber gaskets
 - B) synthetic rubber gaskets
 - C) rubber coated metal gaskets
 - D) All of these

4. The pressure in a gasoline engine combustion chamber can be as high as _____. 4. _____
 - A) 1000 PSI
 - B) 400°
 - C) Both A and B
 - D) Neither A nor B

5. What force causes a head gasket to be drawn downward during engine operation"? 5. _____
 - A) Intake stroke vacuum
 - B) Gravity
 - C) Head bolt torque
 - D) Exhaust gas pressure

6. Which of these is the head gasket?

6. _____

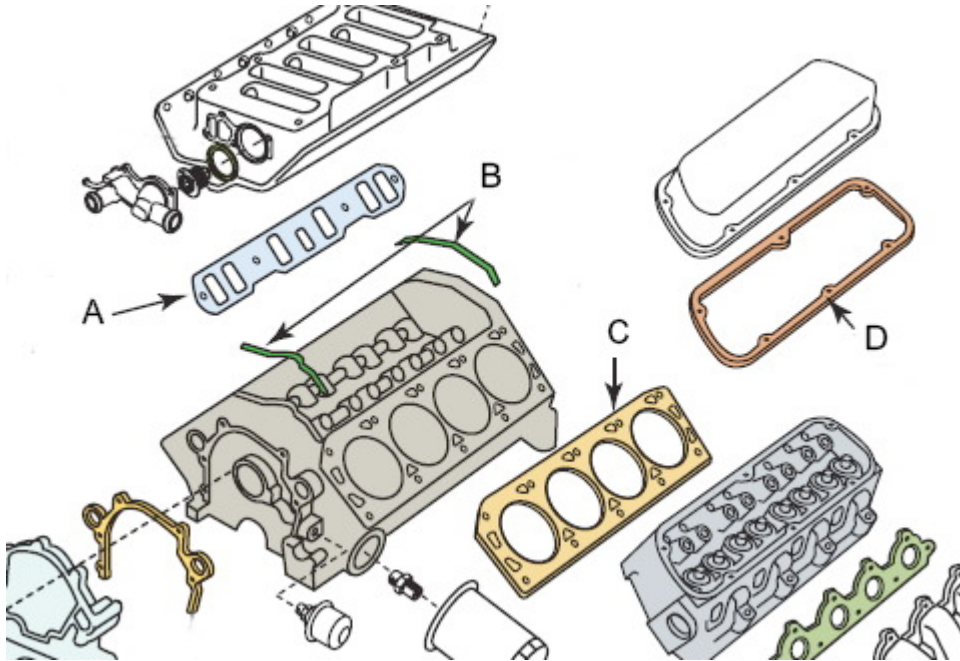

- A) A
- B) B
- C) C
- D) D

7. A plugged PCV system can cause the failure of _____.

7. _____

- A) water pump seals
- B) valve stem seals
- C) the water pump gasket
- D) main oil seals

8. Technician A says that gaskets are used to fill a space or gap between two objects to prevent leakage from occurring. Technician B says that there are many types of gaskets including cylinder head gaskets, valve cover gaskets, and timing cover gaskets. Which technician is correct?

8. _____

- A) Technician A only
- B) Technician B only
- C) Both technicians A and B
- D) Neither technician A nor B

9. What precautions should be followed when using gaskets?

9. _____

- A) Never reuse an old gasket
- B) A gasket should be checked to be sure that it is the correct gasket
- C) Read the instruction sheet
- D) All of the above

10. A gasket failure caused by the movement of dissimilar materials is called _____.

- A) fretting
- B) corrosion
- C) collapsing
- D) tearing

10. _____

Answer Key

Testname: ENGINES 10 32A

1. B
Page Ref: 467
2. C
Page Ref: 467
3. D
Page Ref: 465
4. A
Page Ref: 462
5. A
Page Ref: 462
6. C
Page Ref: 463
7. D
Page Ref: 466
8. C
Page Ref: 462
9. D
Page Ref: 467
10. A
Page Ref: 466